

Flush wood door instructions for contractors

METHOD TO BUILD FLUSH DOOR: USING STOPPER ON INSIDE OF DOOR FRAME

WARNING : Lock cut-out in top corner representative of a standard 80" door.
For taller doors, such as 84" to 96", the top of the cut-out itself needs to stay at 80" from the ground to allow users access to unlock in case of emergency.

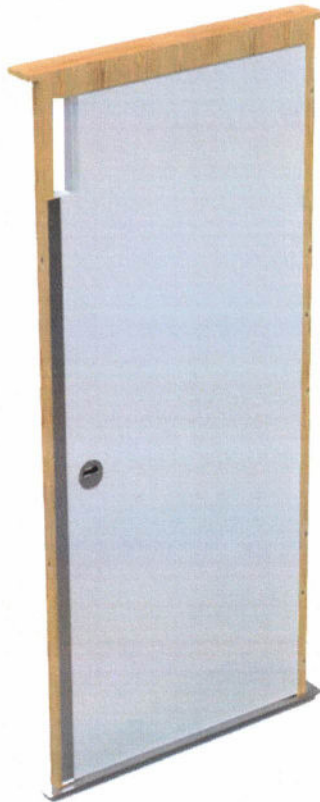

HOISTWAY VIEW
WITH 1/8" SHEET-METAL
STOPPER

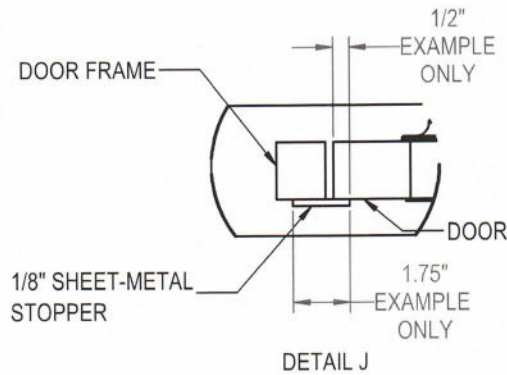
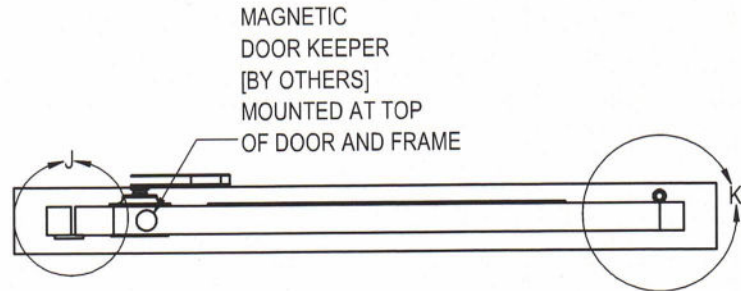

DETAIL J

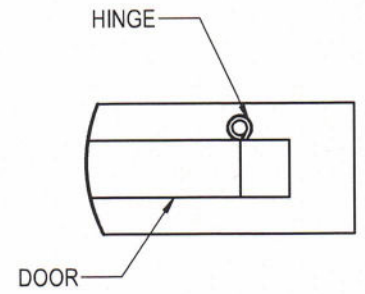

DETAIL K

3X HINGES
(SPRING HINGES OR
DOOR CLOSER
ON HYDRAULIC
ELEVATOR AND
VPL UNITS)

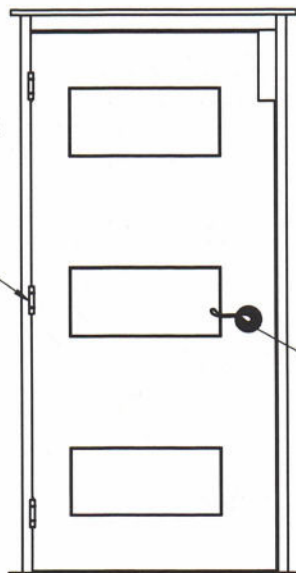

LANDING VIEW

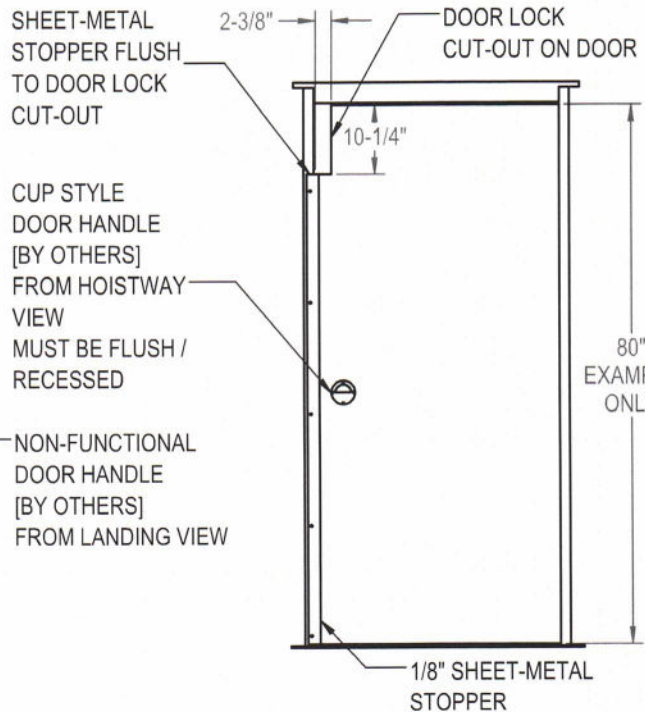

HOISTWAY VIEW

Flush wood door instructions for contractors (cont.)

METHOD TO BUILD FLUSH DOOR USING ANGLE (L) BRACKET STOPPER

WARNING: Lock cut-out in top corner representative of a standard 80" door. For taller doors, such as 84" to 96", the top of the cut-out itself needs to stay at 80" from the ground to allow users access to unlock in case of emergency.

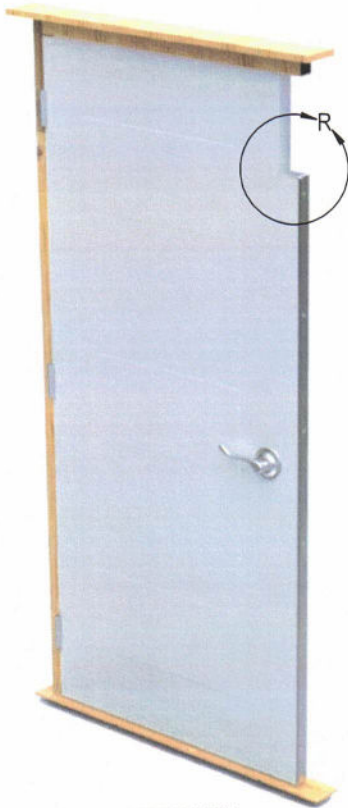

HOUSE VIEW WITH "L" BRACKET STOPPER

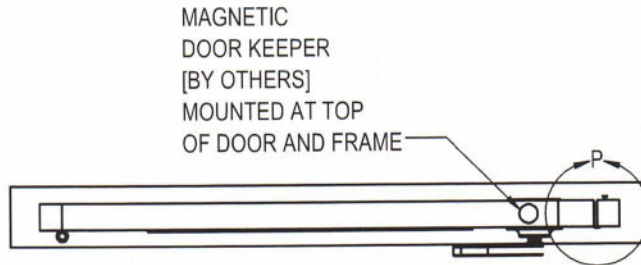

MAGNETIC DOOR KEEPER [BY OTHERS] MOUNTED AT TOP OF DOOR AND FRAME

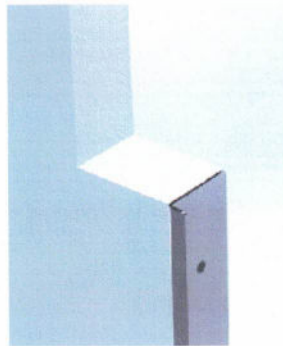

DETAIL M "L" BRACKET MOUNTED ON DOOR SLAB

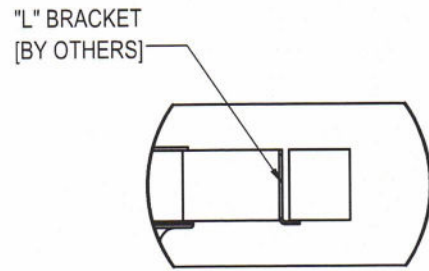

DETAIL P SCALE 1 : 4

CUP STYLE DOOR HANDLE [BY OTHERS] FROM HOISTWAY VIEW MUST BE FLUSH / RECESSED

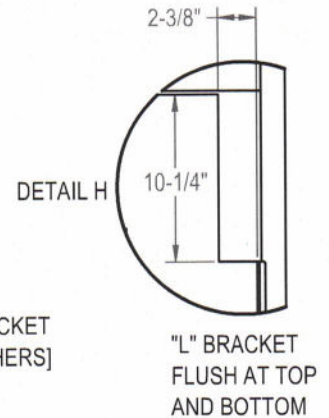
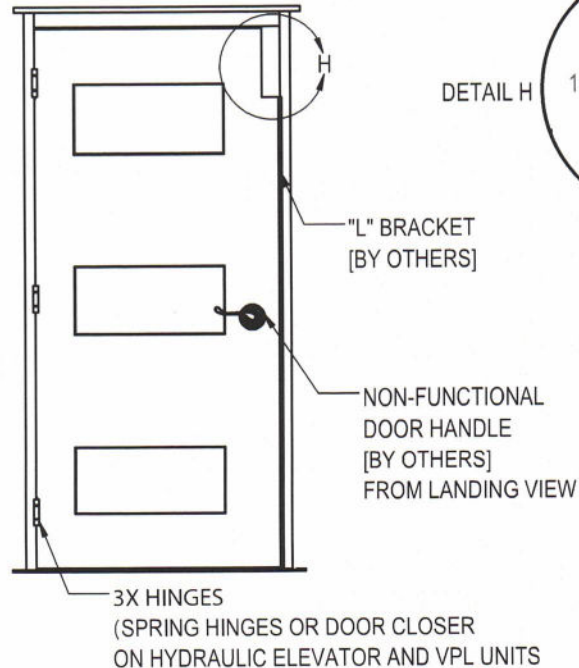
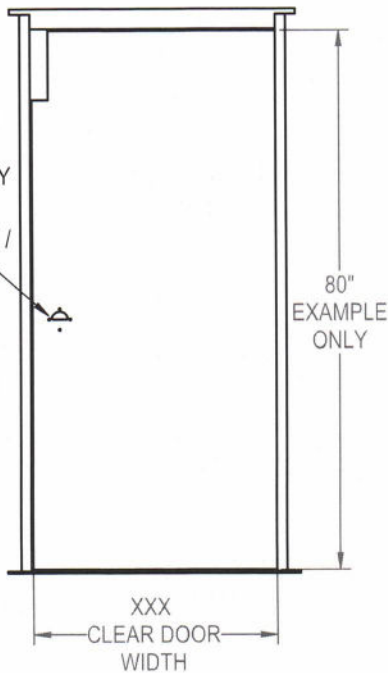

Flush wood door instructions for contractors (cont.)

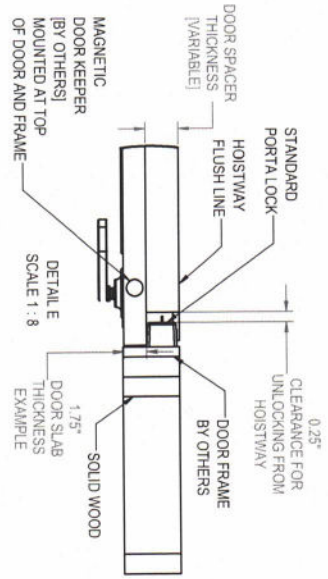

EXAMPLE SHOWN - PLEASE REFER TO FIELD MEASUREMENTS

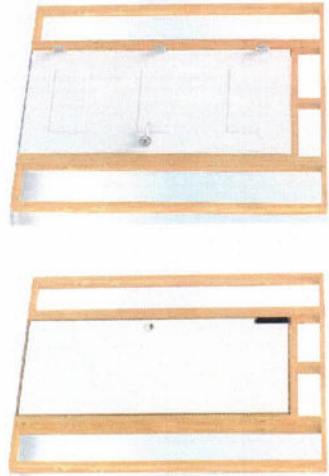

FLUSH DOOR MADE USING DOOR SPACER

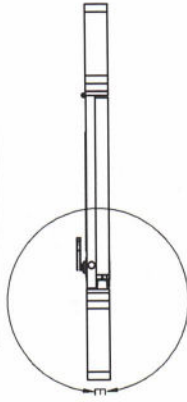
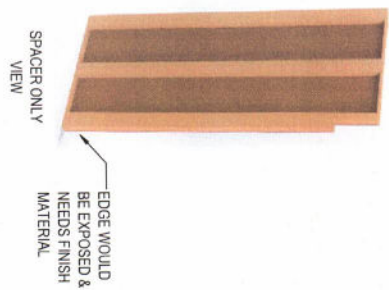
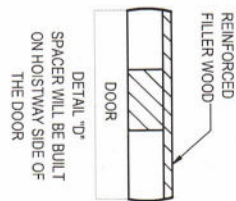

WARNING Lock cut-out in top corner representative of a standard 80" door. For taller doors, such as 84" to 96", the top of the cut-out label needs to stay at 80" from the ground to allow users access to unlock in case of emergency.

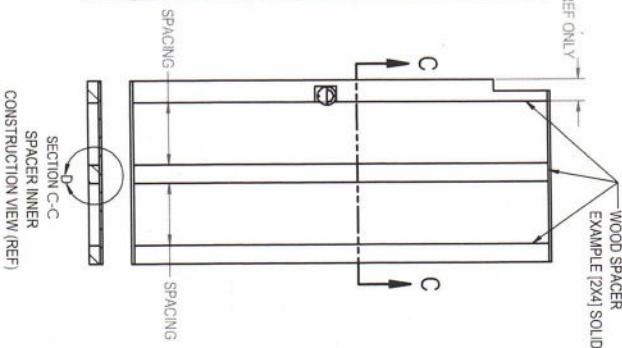
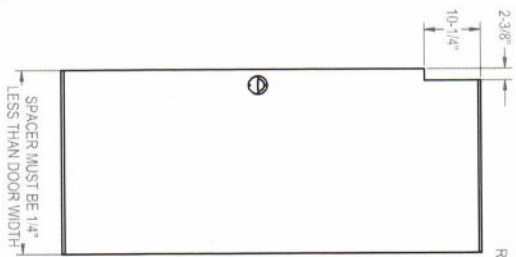
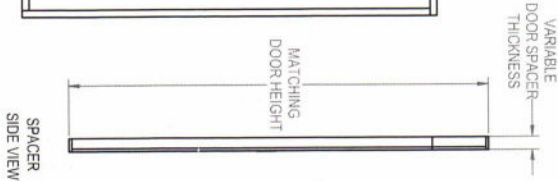
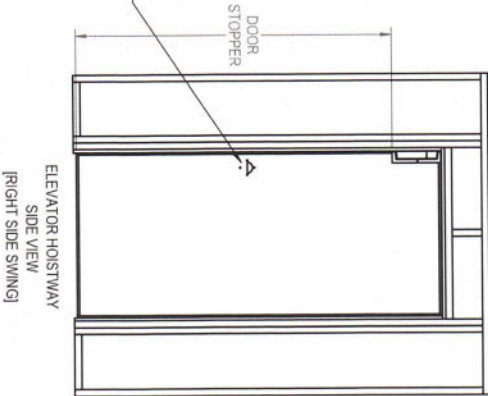
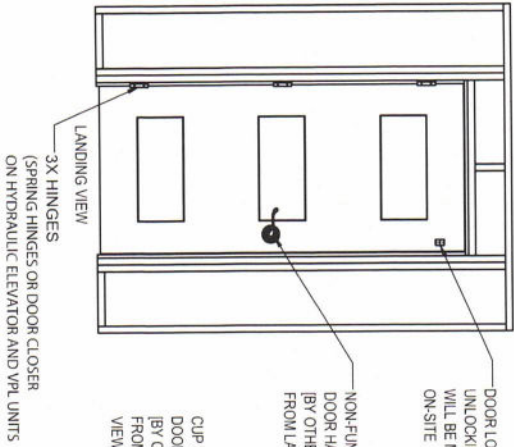

Flush wood door instructions for contractors (cont.)

LOCK CUTOUT DIMENSIONS: FLUSH PORTA LOCK BRACKET

WARNING: Lock cut-out in top corner representative of a standard 80" door. For taller doors, such as 84" to 96", the top of the cut-out itself needs to stay at 80" from the ground to allow users access to unlock in case of emergency.

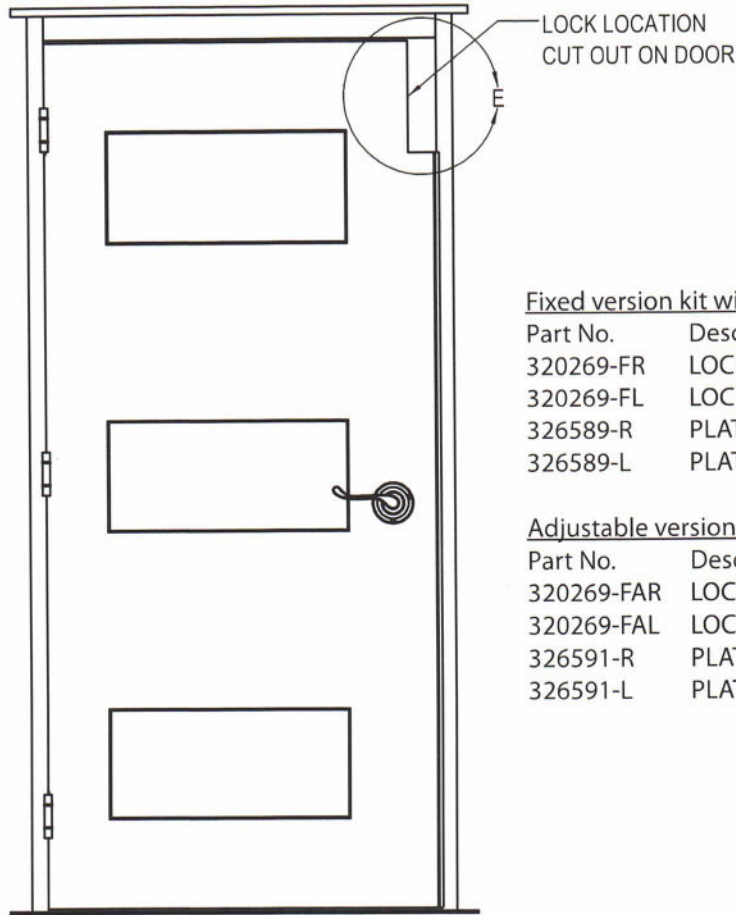

Fixed version kit with lock

Part No.	Description
320269-FR	LOCK_PORTA WOOD DR FLSH, RH ASSY
320269-FL	LOCK_PORTA WOOD DR FLSH, LH ASSY
326589-R	PLATE ONLY, RH
326589-L	PLATE ONLY, LH

Adjustable version kit with lock

Part No.	Description
320269-FAR	LOCK_PORTA WOOD DR FLSH, RH ASSY
320269-FAL	LOCK_PORTA WOOD DR FLSH, LH ASSY
326591-R	PLATE ASSEMBLY ONLY, RH
326591-L	PLATE ASSEMBLY ONLY, LH

LOCK BRACKET OPTIONS:

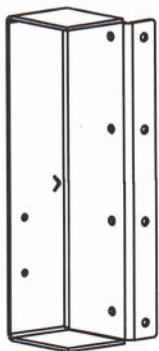

OPTION-1
FOR 1-3/4" DOOR
THICKNESS

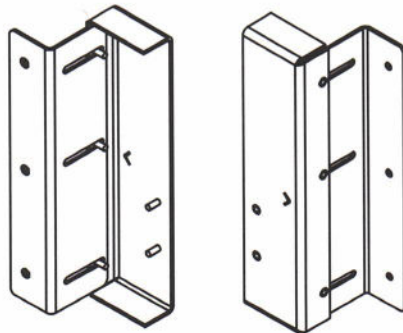

OPTION-2
2 PIECES LOCK
BRACKET FOR 1-1/2" - 2"
DOOR THICKNESS

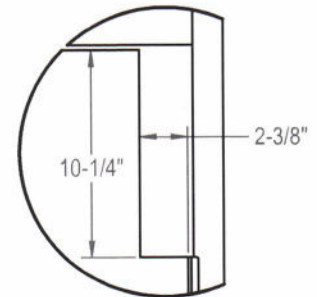

DETAIL E
SCALE 1 : 8